



medemagroup



# Quick guide MC Concept 1121



## Contents

<b>Quick Guide - MC Concept 1121 .....</b>	<b>4</b>
<b>Introduction.....</b>	<b>4</b>
<b>Part names .....</b>	<b>5</b>
<b>Joystick parts .....</b>	<b>6</b>
<b>Operating.....</b>	<b>6</b>
Clock on/off .....	7
Set Speed.....	8
Setting the seat - back and leg supports .....	9
Light on / off.....	10
Setting the display environment .....	11
Setting the Clock .....	12
<b>Error Code.....</b>	<b>14</b>
Charging.....	15
<b>Safety check.....</b>	<b>16</b>
<b>Serial number.....</b>	<b>16</b>
<b>Driving the MC Concept 1121 .....</b>	<b>17</b>
11 tips for driving the MC Concept: .....	18
Driving on public roads: .....	19
Driving on stairs/escalators: .....	19
<b>Brakes.....</b>	<b>20</b>
Motor braking: .....	20
Parking brake: .....	20
Disengagement: .....	20
<b>Your own notes:.....</b>	<b>22</b>



# Quick Guide - MC Concept 1121

## Introduction

Congratulations on your new MC Concept 1121 electric mobility wheelchair. You are now the owner of an electric mobility wheelchair developed for use indoors as well as outdoors. It is what is called a Class B vehicle according to the European classification of electric wheelchairs.

For optimum enjoyment of this vehicle - and to avoid breakdowns and accidents - we recommend that you read the User Manual carefully. If you are a new user, you should pay particular attention to the section "Driving the MC Concept 1121".

### **Note:**

This Quick Guide is to be regarded as a supplement to the User Manual. The information in the Quick Guide cannot, therefore, be expected to be complete.

NB: Errors and omissions excepted. Specifications subject to change.

We reserve the right to update this guide as required.

---

### **Warning!**

The vehicle must not be lent to persons who are not completely familiar with it.

The vehicle is designed for one person only.

Max. user weight 150 kg. The vehicle can be specially adapted at the factory for users weighing up to 180 kg.

Mini Crosser A/S is not responsible for any damage or injuries caused by inappropriate or unsafe use of the MC Concept 1121.



# Part names

The part names given below refer to the descriptions later in the this guide.



## Joystick parts

Dynamic DX2 AJR		
	1	Start/stop button
	2	Indicator left
	3	Indicator right
	4	Select
	5	Display
	6	Speed selector
	7	Accessory Selector
	8	Horn

## Operating

At the top of the display you will find the status bar. Battery indicator is displayed constantly. The clock can be turned on or off as you wish. The other is lit when the corresponding function is active.

	
	1 2 3 4 5 6
1	Battery indicator Green = fully charged Yellow = least half full Red = almost empty - charge now!
2	Indicator left is active When hazard warning lights are active, both icons blinks.
3	Lights on
4	Error code - see section on error codes.
5	Indicator right is active When hazard warning lights are active, both icons blinks.
6	Real time



### Clock on/off



Press arrow up/down or joystick (push forward) until the above icon is showed in the center of the screen.



Use "Select" to switch between X and ✓.

Accept by pressing the arrow up/down button.

## Set Speed

When you turn the joystick on, the image shown below will be presented in the display. The number in the centre shows the speed you have chosen as max speed. Change the Speed by selecting the plus / minus key. Maximum speed is 5, lowest is 1.

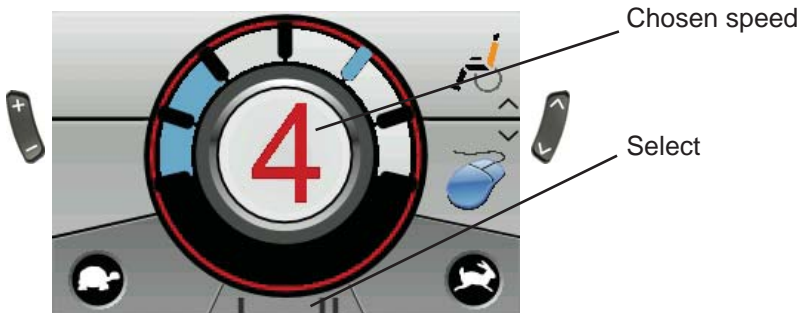

Find the features in the bottom with the “Select” button.

### Setting the seat - back and leg supports

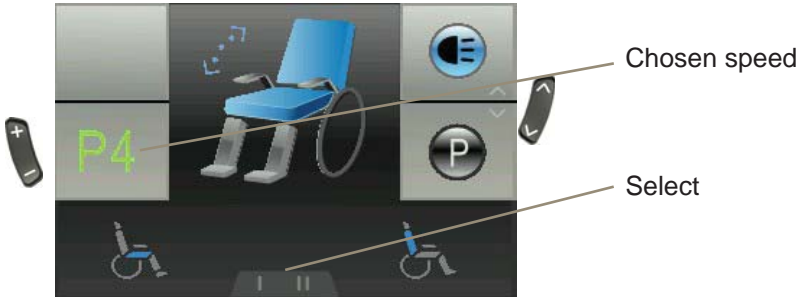

Press the arrow up / down until the image shows the chair. Use the “Select” to choose the function you want modified. Use the joystick to change example angle of the seat back.

Function	Icon
Seat angle (Tilt)	
Backrest angle	
Seat height	
Left footrest	

Function	Icon
Right footrest	
footrest both	
Lying down	
Headrest	

Only the available options will be displayed.

## Light on / off

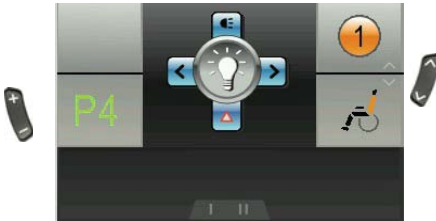

Push the arrow up / down until the image for light is shown in the centre.

Push the joystick forward to turn the light on. And again to turn of the light.

Push the joystick back to activate the hazard warning lights. Push the joystick back again to turn it of.

Push the joystick right or left to activate the indicators right or left. Turn of the indicators by puching the joystick to the same side again.

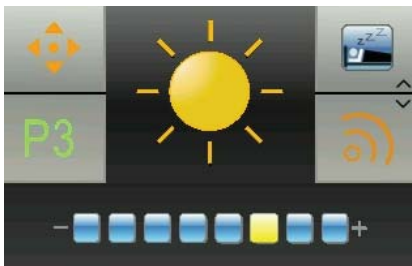

Press the arrow up / down until the sun i shown i the centre. Push the joystick forward to enter the settings. Use the Select button or joystick right / left to change the brightness.

Use Joystick forward / back or arrow up / down to accept the new settings and return to the main menu.

## Setting the display environment

Use the arrows up /down until “day / night” icon i shown in the centre. Push the joystick forward to enter settings. The image below will show.

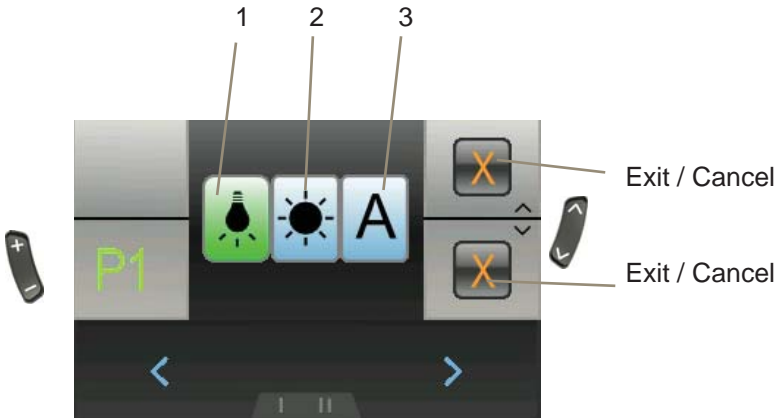

Setting	Result
1 - Indoor	The display will show a black background color.
2 - Outdoor	The display will show a white background color.
3 - Automatic	The background color will change (black/white) accordingly to the surrounding light.

Use "Select" or joystick right / left to select setting.

Push the joystick forward to accept the new settings and return to the main menu.

If you push the Joystick back or use the arrow up / down, the new setting will be dismissed and you will return to the main menu.

## Setting the Clock



Use arrow up / down until the clock is shown in the centre. Push the joystick forward to enter settings. The image below will show.

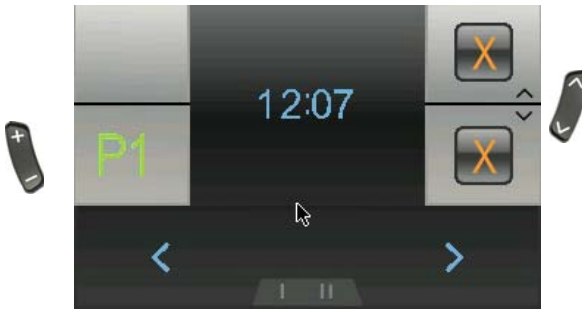

Press the Select button or push the joystick right / left to choose the digit to change.

Joystick forward make the number count forward.

Joystick back accept the new settings and return to the main menu.

Arrow up / down dismiss the new settings and return to the main menu.

## System lock



<b>To lock the DX system</b>	
	Press the on / off button, for 4 sec. while the system is turned on. The system will now shut down in locked condition.



<b>To unlock the DX system</b>	
	Press the on / off button. The system will show a lock in the display.
	Press the horn twice within 10 seconds. The system will boot normally.



## Error Code

Code	Cause	Meaning
1	DX Module	<p>Could mean:</p> <ul style="list-style-type: none"> <li>- Errors in programming</li> <li>- Error in wire connection</li> <li>- Internal fault in a module</li> </ul> <p>Turn off the chair and turn on again. If it doesn't work, contact qualified technician (HMC or therapist).</p>
2	DX Accessory	<p>Could mean:</p> <ul style="list-style-type: none"> <li>- driving slowly because of raised seat. (programming). Not an error.</li> </ul> <p>Lower the seat as much as possible. If it doesn't work, contact qualified technician (HMC or therapist).</p>
3	Motor 1 / L (M1)	<p>Could mean:</p> <ul style="list-style-type: none"> <li>- Loose connection from the engine to power module</li> <li>- Short circuit</li> </ul> <p>Check that no plug is loose. Contact competent technician (HMC or therapist).</p>
4	Motor 2 / L (M2)	<p>Could mean:</p> <ul style="list-style-type: none"> <li>- Loose connection from the engine to power module</li> <li>- Short circuit</li> </ul> <p>Check that no plug is loose. Contact competent technician (HMC or therapist).</p>
5	Parking brake 1 (M1 left)	<p>Could mean:</p> <ul style="list-style-type: none"> <li>- Loose connection</li> <li>- Short circuit</li> </ul> <p>Check that no plug is loose. Contact competent technician (HMC or therapist).</p>
6	Parking brake 2 (M2 right)	<p>Could mean:</p> <ul style="list-style-type: none"> <li>- Loose connection</li> <li>- Short circuit</li> </ul> <p>Check that no plug is loose. Contact competent technician (HMC or therapist).</p>



## Charging

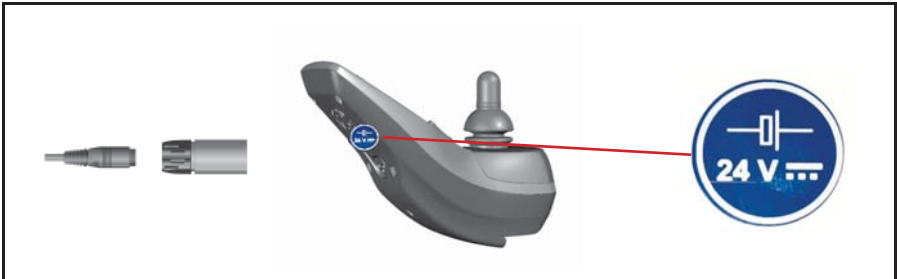

### Charging

1	Plug the cable into the control box on the wheelchair
2	Plug the charger into the outlet or switch it on
3	Use the indicator lights on the charger to check that charging has started.
4	When charging has finished, switch off or unplug the charger, and then remove the charger cable from the control box.

You are recommended to charge the batteries every night after you have used the wheelchair. (Further information in the User Manual)

### Note:

If the batteries are damaged or are leaking, you should avoid touching them because you may burn yourself.

Contact a qualified workshop immediately!

Old batteries must be delivered to an approved facility for safe disposal.

Further information in the User Manual.

## Safety check

See the User Manual

---

## Serial number

All wheelchairs have a serial number plate showing the year of production, month and serial number. The same serial number can also be found on the front of the User Manual.

**Please quote the serial number when making inquiries about servicing, spare parts, etc.**



## Driving the MC Concept 1121

Before getting on or off the vehicle, you must check the following:

- A. That the wheelchair is switched off and that it is not disengaged.
- B. That the wheelchair and the seat you are moving to are both stable.
- C. Avoid placing your full body weight on the footrests. This may tip the wheelchair forwards.

While driving, you must place your arms on the armrests and your feet on the footrests.

Cables and leads must be fixed using ties.

Never attempt to climb onto raised objects or kerbs higher than 7 cm, and always approach changes of level head on, with the front and back wheels moving in a straight line.

### **Warning!**

The seat should NEVER be hoisted while driving on uneven surfaces, slopes or up and down kerbs. The higher the seat is raised, the more unstable the chair becomes.

### **Note:**

**If your MC Concept/vehicle is fitted with a docking system from Dahl Engineering, note that the clearance changes to 5.5 cm.**

See the User Manual for details about driving on hills, inclines and declines, and driving on public roads.



## 11 tips for driving the MC Concept:

- Reduce the speed when turning corners and also when going downhill.
- Reduce the speed when driving on inclines. Max. incline =  $10^\circ = 17\%$
- Reduce the speed when driving on a sideways incline.  
Max. sideways incline =  $10^\circ$
- Avoid driving and parking in the rain.
- Avoid parking on snow and ice.
- Always park on a level (flat) surface.
- Avoid driving off-road.
- Avoid driving on icy surfaces, or smooth surfaces (for example snow or freshly mown grass).
- Never attempt to climb kerbs higher than 7 cm. If the wheelchair has a docking system, the clearance is reduced to 5.5 cm.
- Avoiding driving over kerbs diagonally. There is a risk of tipping over.
- Not to be used for towing other vehicles, etc.

### **Note:**

Do not drive the MC Concept when under the influence. This applies to both medicine and alcohol.



**Driving on public roads:**

When driving on public roads, footpaths, pedestrian streets, car parks, shopping centres, etc. you must make sure you adjust your speed and distance for other users. At 7 km/h you must follow the traffic rules applicable to cyclists. This also means that your lights must be switched on during lighting-up time. (Optional extra)

On footpaths, the maximum speed is 6 km/h. In this situation you are regarded as a pedestrian.

**Note:**

You should assume that other road users cannot see you while you are sitting in the MC Concept. So take great care and wait for the road to clear before crossing.

**Driving on stairs/escalators:**

The wheelchair is not designed for use on stairs or escalators and any attempt to do so may cause serious injury to yourself and others.



## Brakes

The MC Concept is equipped with two sets of brakes: the motor brake and the parking brake.

### **Motor braking:**

When you drive downhill, the control unit of the MC Concept applies the motor brake.

### **Parking brake:**

When the vehicle is stationary and the joystick is not moved, a magnetic brake is automatically applied to each drive unit.

### **Note:**

You must NEVER brake the MC Concept by switching off with the 1/0 button while moving, as this applies the magnetic brake with considerable force, with a resulting risk of tipping.

### **Disengagement:**

The MC Concept is equipped with two disengagement levers, one on each side of the vehicle. Always disengage on both sides.

### **Warning!**

When the wheelchair is disengaged, the braking system is deactivated. You must NEVER disengage on sloping terrain



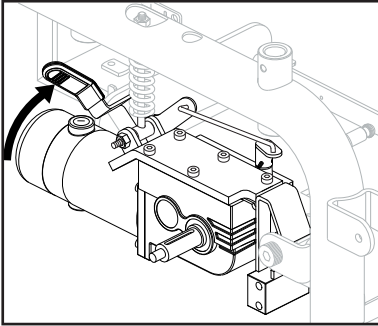

*Normal position for driving - pushed up*

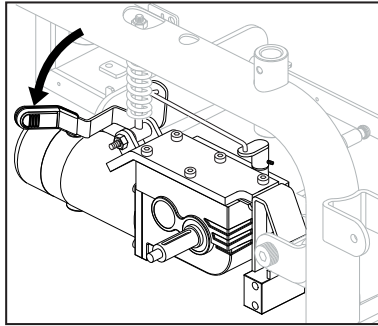

*Position for disengagement - pushed down*

## Your own notes:







**medemagroup**